

## 8'2" Box

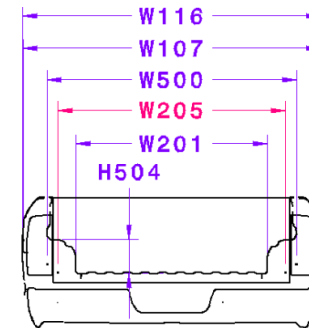
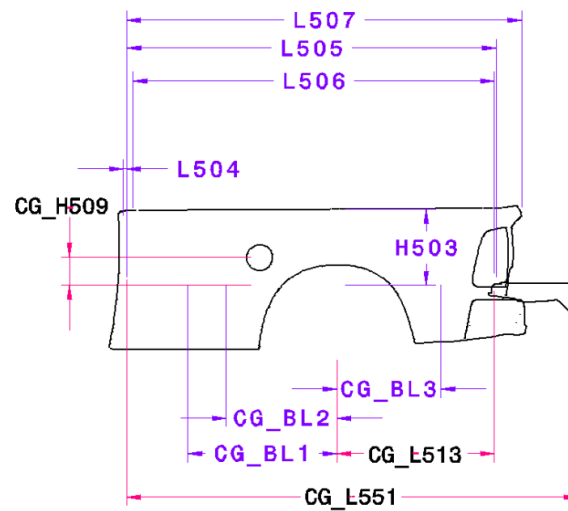
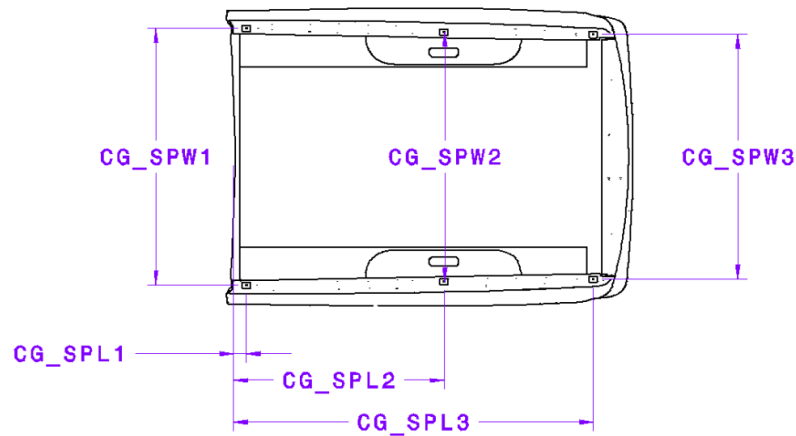

**BBG TEMPLATE**

## 8'2" Box

Code	Description	Metric	English
CG_BHS	Bulkhead Opening Size*	38.0 x 106.0	1.5 x 4.2
CG_BL1	Front Bulkhead to Rear Axle	1009.3 mm	39.7 in
CG_BL2	Middle Bulkhead to Rear Axle	748.3 mm	29.5 in
CG_BL3	Rear Bulkhead to Rear Axle	702.1 mm	27.6 in
CG_SPL1	Front of Bed to Front Pocket	86.5 mm	3.4 in
CG_SPL2	Front of Bed to Middle Pocket	1423.3 mm	56.0 in
CG_SPL3	Front of Bed to Rear Pocket	2433.4 mm	95.8 in
CG_SPS	Stake Pocket Opening Size*	50.0 x 35.0	2.0 x 1.3
CG_SPW1	Width between Front Pockets	1737.8 mm	68.4 in
CG_SPW2	Width between Middle Pockets	1689.0 mm	66.5 in
CG_SPW3	Width between Rear Pockets	1654.0 mm	65.1 in
CG_H509	Box Floor to Center of Fuel Door	189.1 mm	7.4 in
CG_L513	Rear Axle to Inside Box at Rear	1066.3 mm	42.0 in
CG_L551	Front of Box to end of open Tailgate	3054.3 mm	120.2 in
H503	Pickup Body Height	513.0 mm	20.2 in
H504	Wheelhouse height	228.2 mm	9.0 in
L504	Cab to Pickup Body	21.0 mm	0.8 in
L505	Pickup Body Length at Floor	2496.5 mm	98.3 in
L506	Pickup Body Length at Top of Body	2445.1 mm	96.3 in
L507	Pickup Body Overall Length	2674.3 mm	105.3 in
V5	Open Truck Cargo Volume Index-Maximum	2.1 m <sup>3</sup>	74.7 cuFt
W107	Fender Width - Rear	2013.1 mm	79.3 in
W116	Body Width - Maximum	2017.4 mm	79.4 in
W201	Cargo Width-Wheelhouse	1295.4 mm	51.0 in
W205	Tailgate Opening	1535.3 mm	60.4 in
W500	Cargo Width at Rear	1686.9 mm	66.4 in

BBG TEMPLATE